

PLAN SHOWING THE PROPOSED RESIDENTIAL BUILDING IN PLOT NO: 30B, S.NO:22, V.NO:144, SEEVARAM VILLAGE, SENTHIL NAGAR, NEELANKARAI, TAMBARAM CIRCLE, CHENGAI ANNA DISTRICT.



SCALE - 1" = 8' 0"

OWNER: M. SUSEELA

REFERENCE

- DOOR : D : 3'3" X 6'6" (100 X 198)
- : D1 : 3'0" X 6'6" (90 X 198)
- : D2 : 2'6" X 6'6" (76 X 198)
- WINDOW : W : 5'0" X 4'0" (152 X 122)
- : W1 : 4'0" X 4'0" (122 X 122)
- : W2 : 3'0" X 4'0" (90 X 122)
- VENTILATOR: V : 3'0" X 2'0" (90 X 60)
- GRILL : G : 5'0" X 4'0" (152 X 122)

AREA DETAIL

PLOT AREA : 1200 SFT 111.48 M²
 PLINTH AREA: 619.75 SFT 57.22 M²
 PORTICO AREA: 67.00 SFT 6.23 M²
 P.C. 62.2% F.S.I. 0.622

COLOUR INDEX

- PROPOSED
- ROAD
- BOUNDARY

OWNER
 M. Suseela

K. Nagarajan, D.C., D.C.E., D'CAD,
 LICENSED SURVEYOR
 LANDUR & TAMBARAM MUNICIPALITY
 OFF: 2915, RANGANATHAN STREET
 Opp: Mambalam Rly. Station
 LICENSURE NO: 600017
 Phone: 4348676

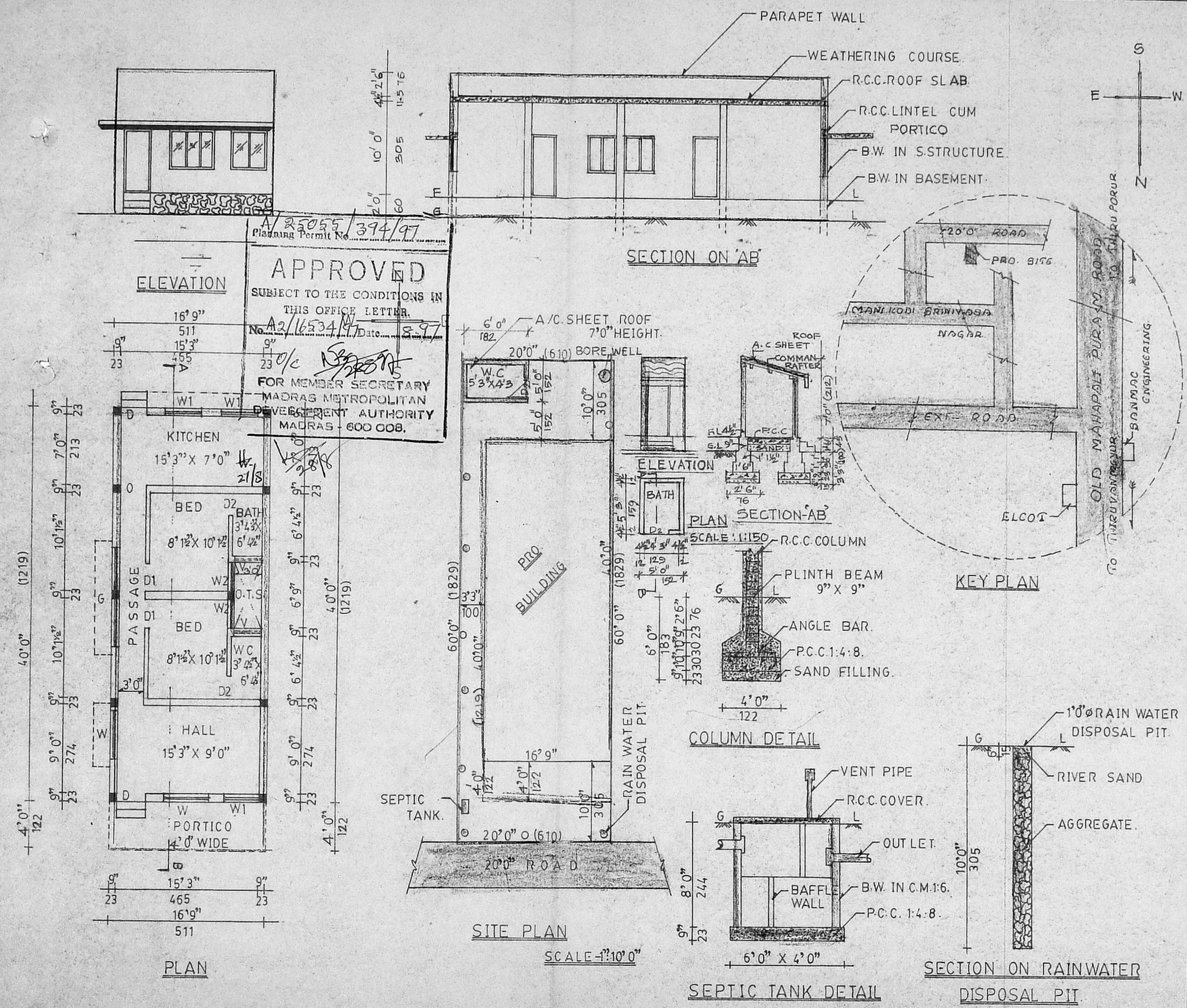

APPROVED
 SUBJECT TO THE CONDITIONS IN THIS OFFICE LETTER.
 No. A2/16534/97 Date: 8/9/97
 FOR MEMBER SECRETARY
 MADRAS METROPOLITAN DEVELOPMENT AUTHORITY
 MADRAS - 600 008.